

Measure

Accurate measurement is the foundation of any design

1

Internal dimensions

Start with a large piece of plain or graph paper. The layout can always be transferred to a computer program later. **Measure all the internal dimensions in millimetres**, not forgetting to allow for plaster and board if you are measuring off block-work.

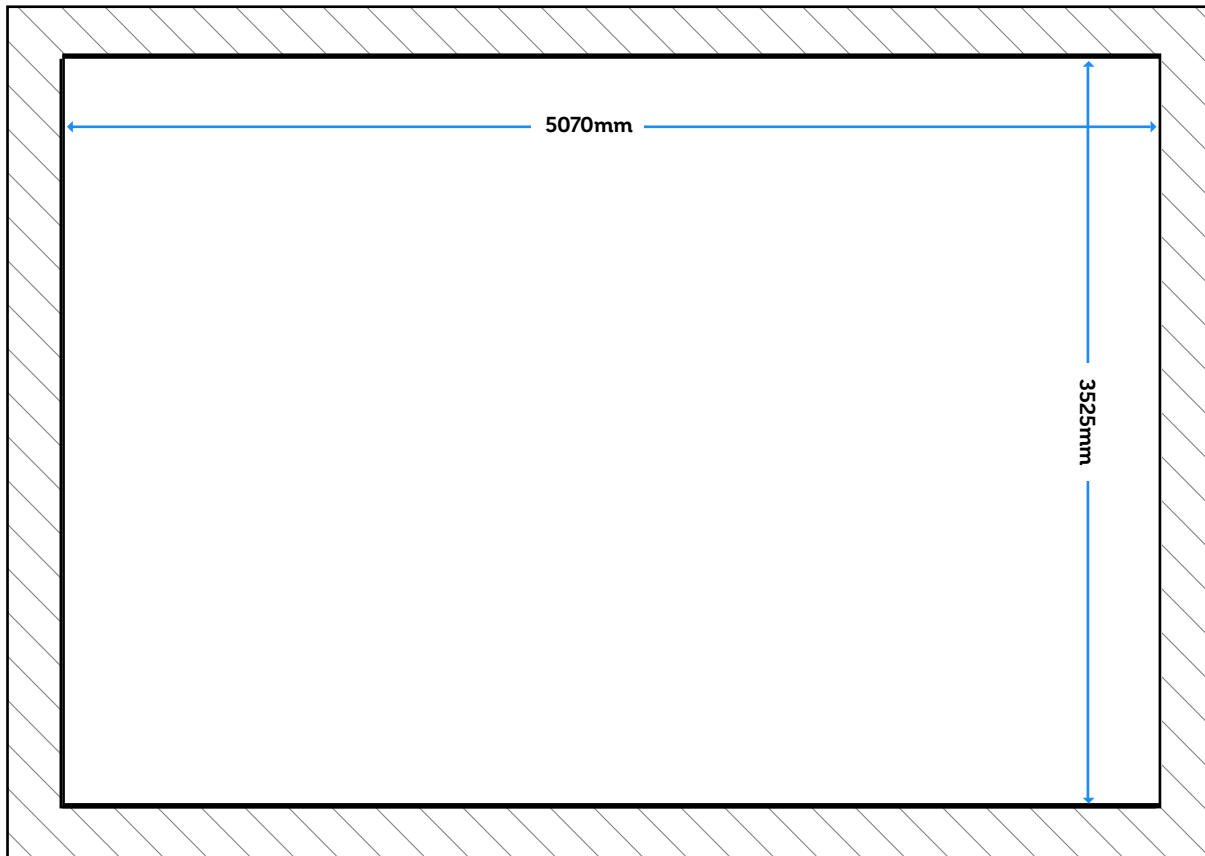

2

Windows & Doors

Measure and mark on your plan the position of all **windows including width, height to underside and top**. Allow for any windowboards or cills. **Measure and mark** on the plan all **width and height of all doors**, not forgetting to allow for architraves if fitted.

(a.)

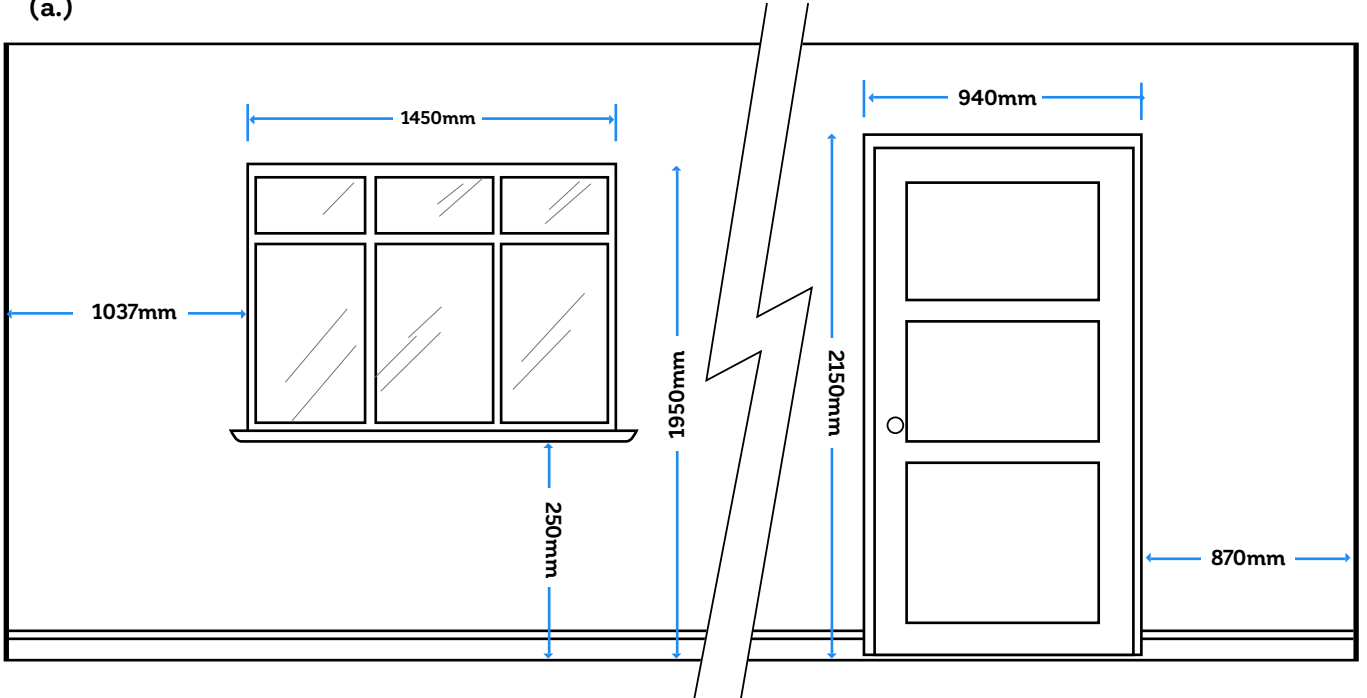

(b.)

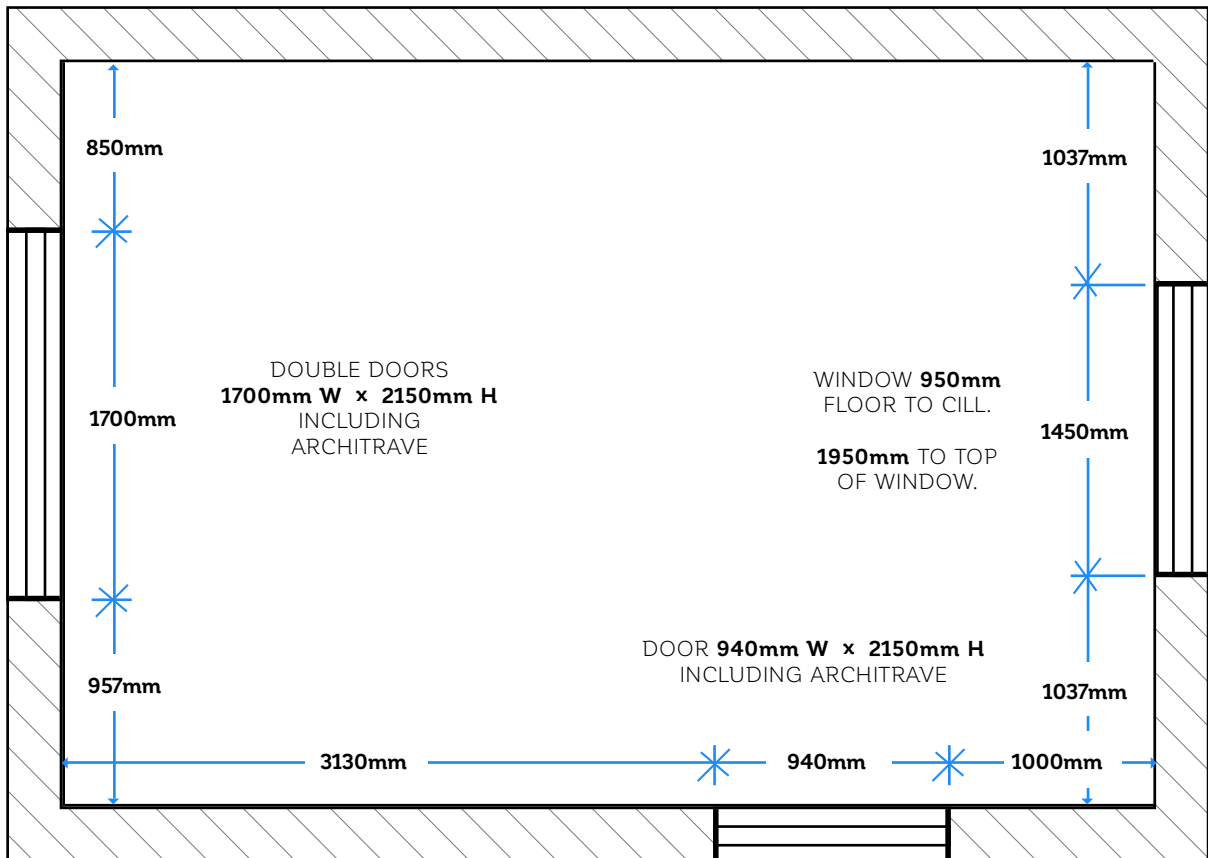

3

Ceiling

Measure and mark on your plan the **ceiling height from the floor at several different points in the room**, allowing for plaster and board if not already fitted.

Pay particular attention to any steel RSJ's or other beams. **Make a note** of **what floor covering will be installed**, including any screed or adhesive, and take the thickness of this off your height dimensions.

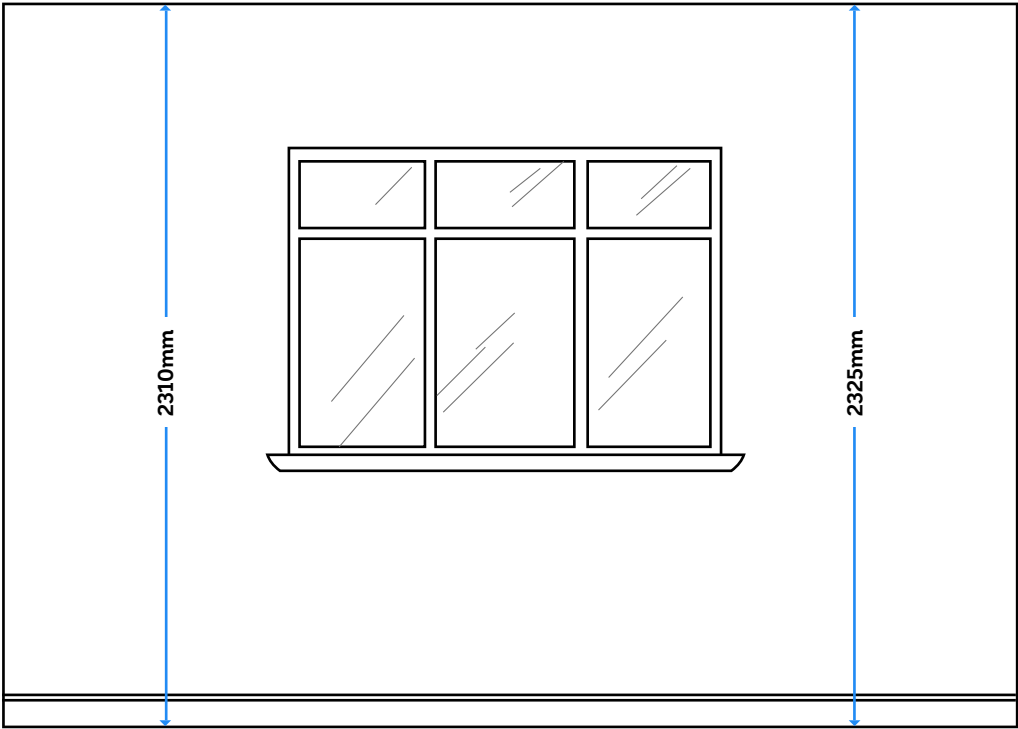

4

Services

Make a note of all the services in the room, gas, electricity, existing or planned plumbing and waste drainage, whether connected or just shown on the architects drawings, and transfer these to your plan, showing heights from the floor, and protrusion out from the walls.

